

MM100

ITEM NO.	PART NUMBER	DESCRIPTION	QTY.
1	82001	N45M ROUND MAGNET MOUNT, 26 LBS., 5MM HOLE SIZE	3
2	29510	#10-32 X 3/4" PHILLIPS DRIVE FLAT HEAD ZINC FINISH STEEL MACHINE SCREW	3
3	29514	#10-32 X 1 MACHINE SCREW, FLAT HEAD CROSS RECESSED, ZINC	3
4	37015	10-32 Grade 2 Zinc Finish NM Steel Nylon Insert Lock Nut	3

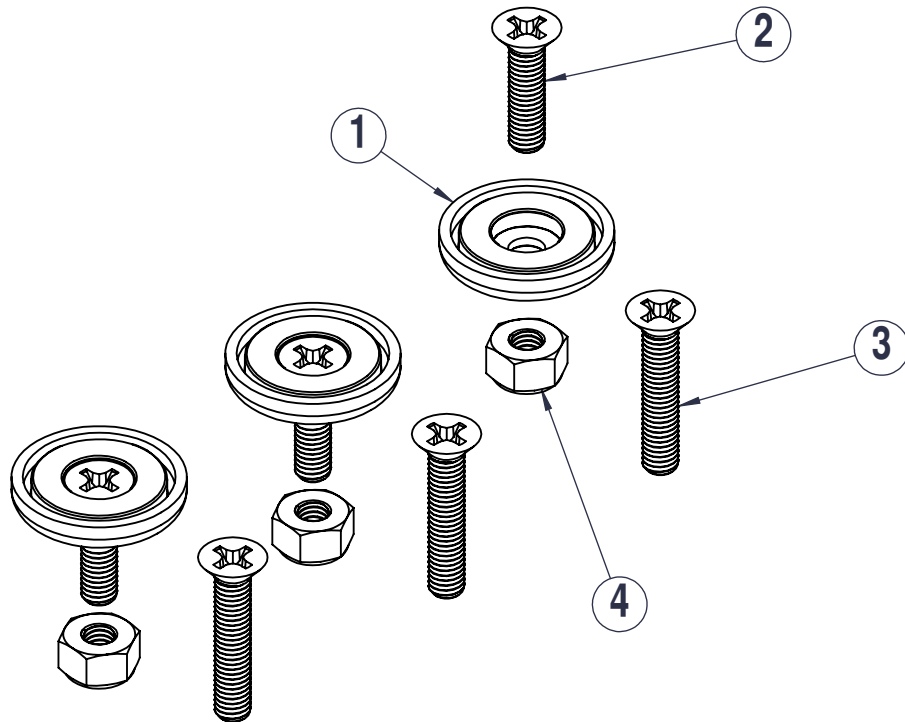

**NOTES:**  
**PULL STRENGTH 26 LBS MINIMUM USING 3.0MM 1008-1010 STEEL PLATE**

CONFIDENTIAL: USE OF THIS DRAWING WITHOUT WRITTEN AUTHORIZATION BY MAGDADDY IS PROHIBITED		GENERAL TOLERANCE UNLESS OTHERWISE SPECIFIED: $\pm .51$ ANGLES: $\pm 5^\circ$	
UNCONTROLLED DOCUMENT IF PRINTED		INCH MM	SCALE: 2:1 Sheet Size <b>A</b>
THIRD ANGLE PROJECTION  SYMBOLS ARE PER ANSI Y14.5M-1982		<b>MAG DADDY</b> MAGNETIC FASTENERS	
MATERIAL:		CK.	DWN. <b>SS</b> DATE: 02/21/2022
SEE NOTES		PART DESCRIPTION: <b>MAGNETIC CAMERA MOUNT</b> PART NO. <b>MM100</b>	

REV	DATE	BY	E.C.R.	DESCRIPTION
	02/22/2022	SS		RELEASED
LATEST REVISION SHOWN, REVISION HISTORY IS IN EPDM DATABASE				